

DETALHE EXTERNO 01 - VAGAS PREFERENCIAIS

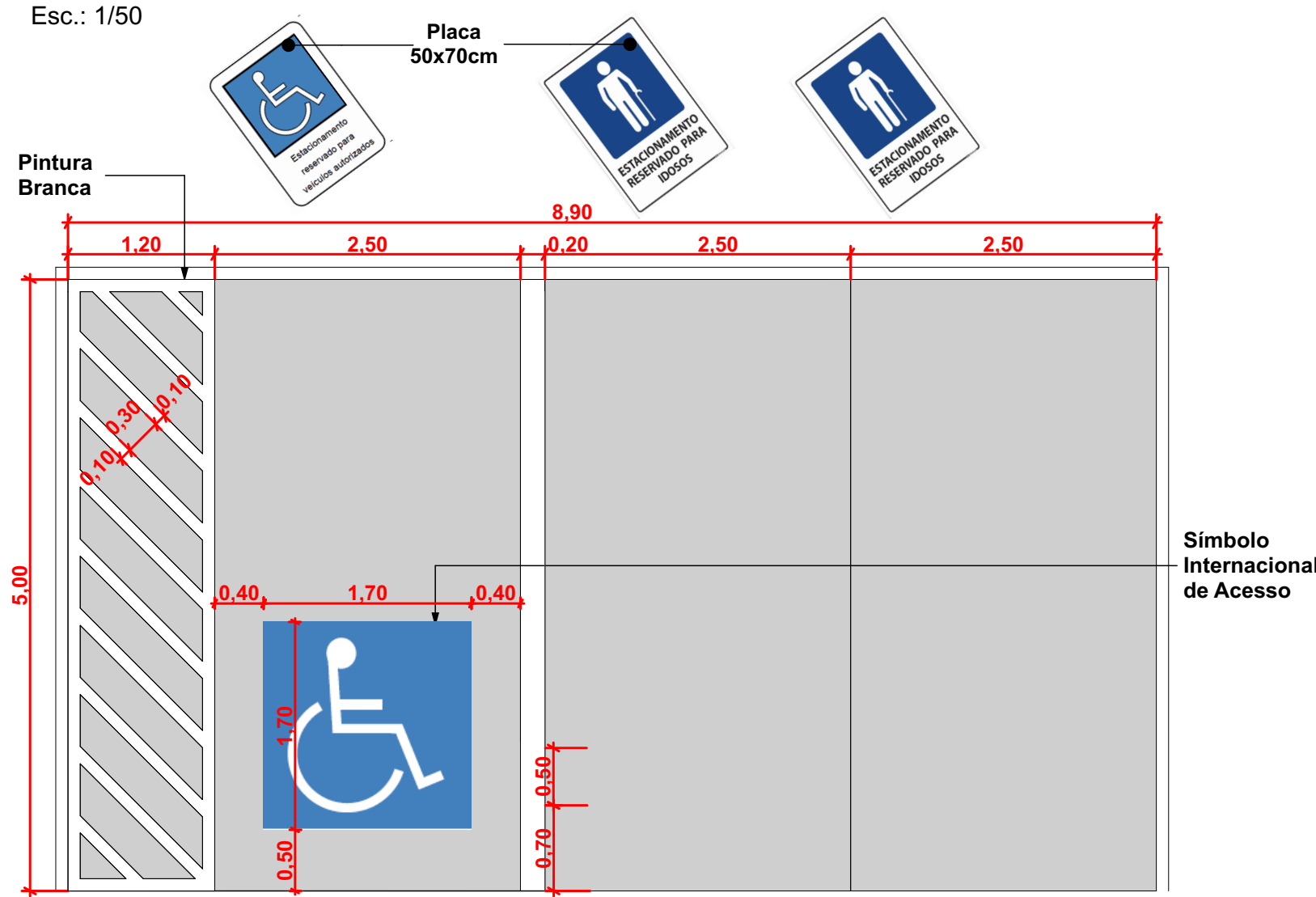

DETALHE 02 - RAMPA

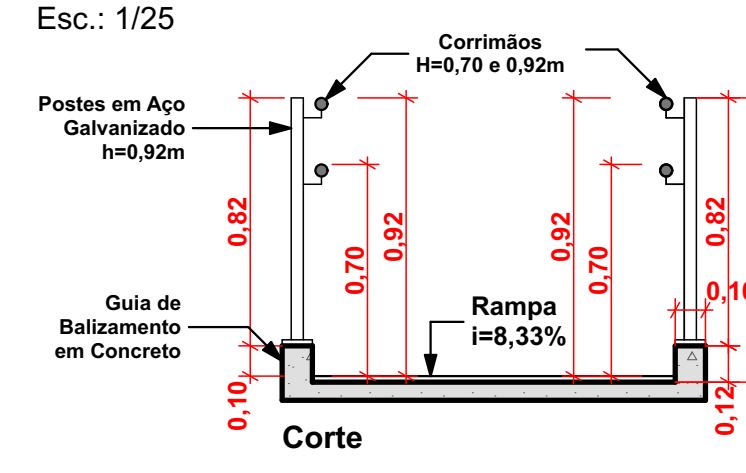

DETALHE 02- SOLEIRA PORTAS

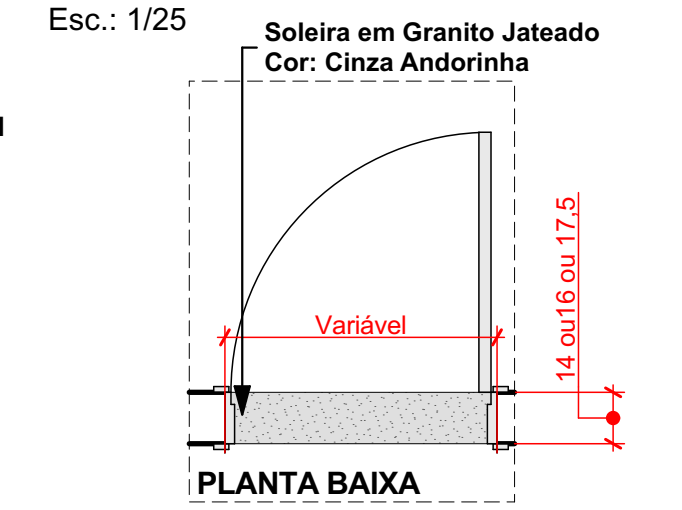

DETALHE 08 - CORRIMÃO DUPLA

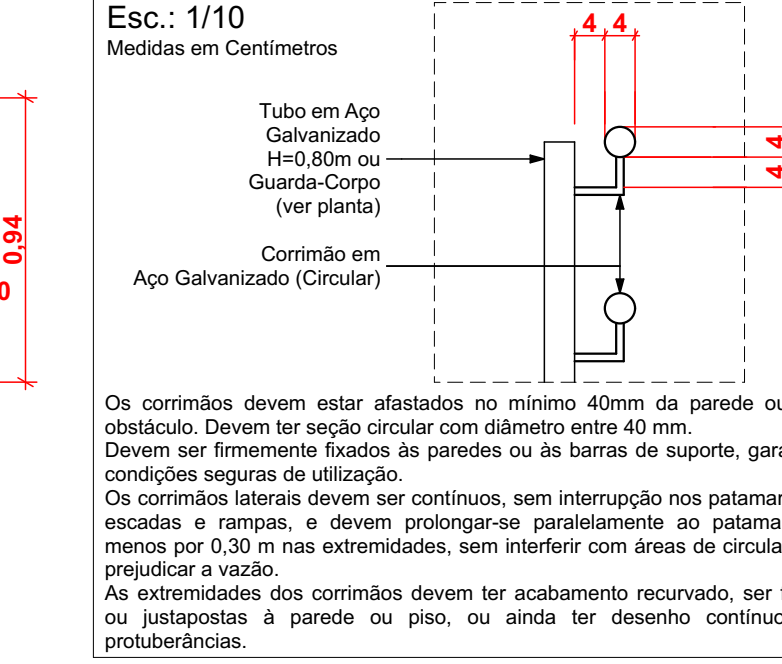

DETALHE 09 - RAMPA

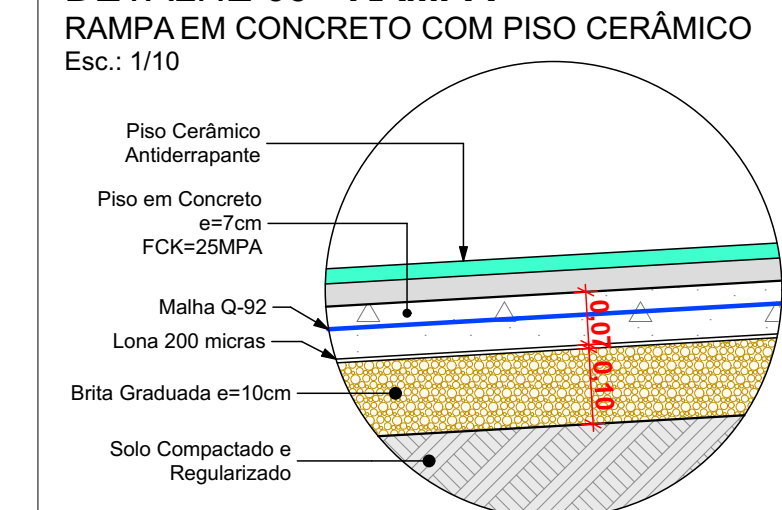

DETALHE 03- SOLEIRA JANELAS

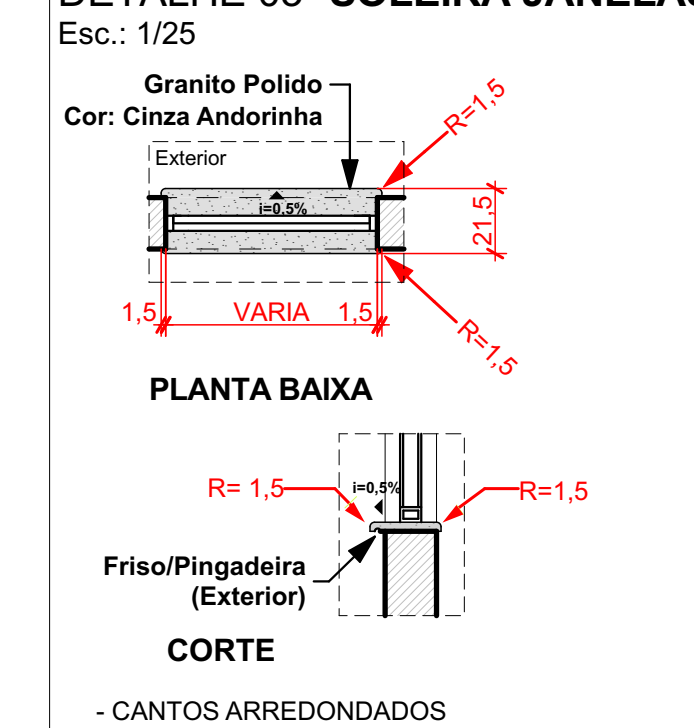

DETALHE 06 - MICTÓRIO COM BARRAS DE APOIO

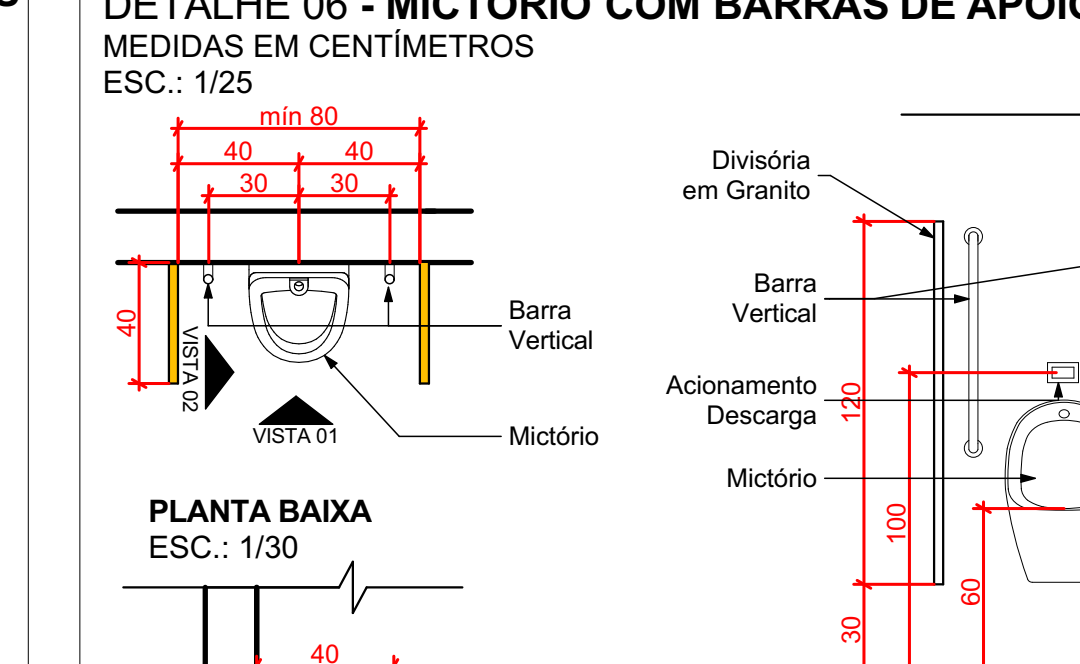

DETALHE 06 - MICTÓRIO COM BARRAS DE APOIO

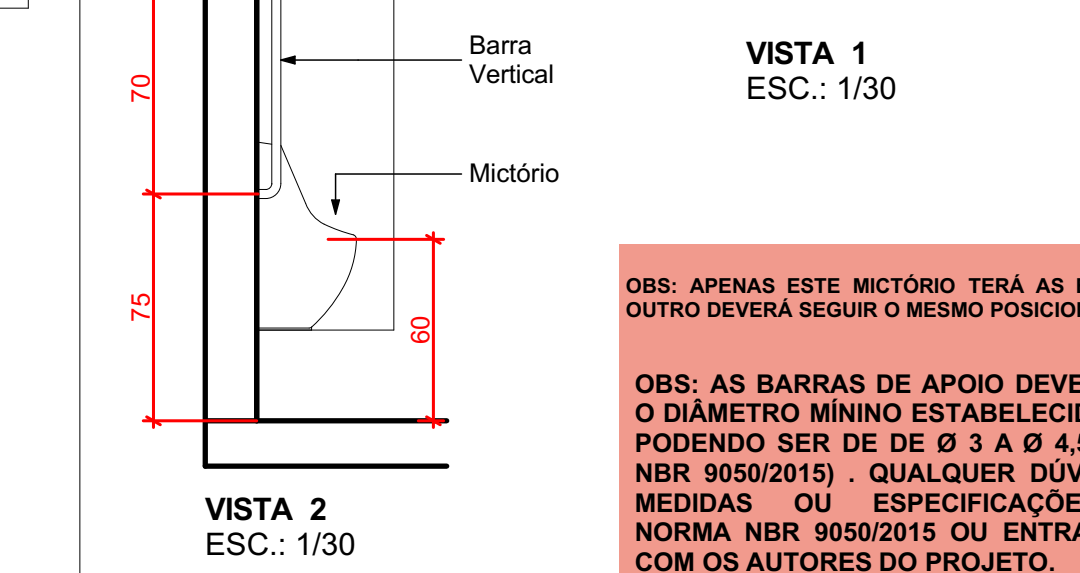

JANELA 01 - 02 FOLHAS BASCULANTES

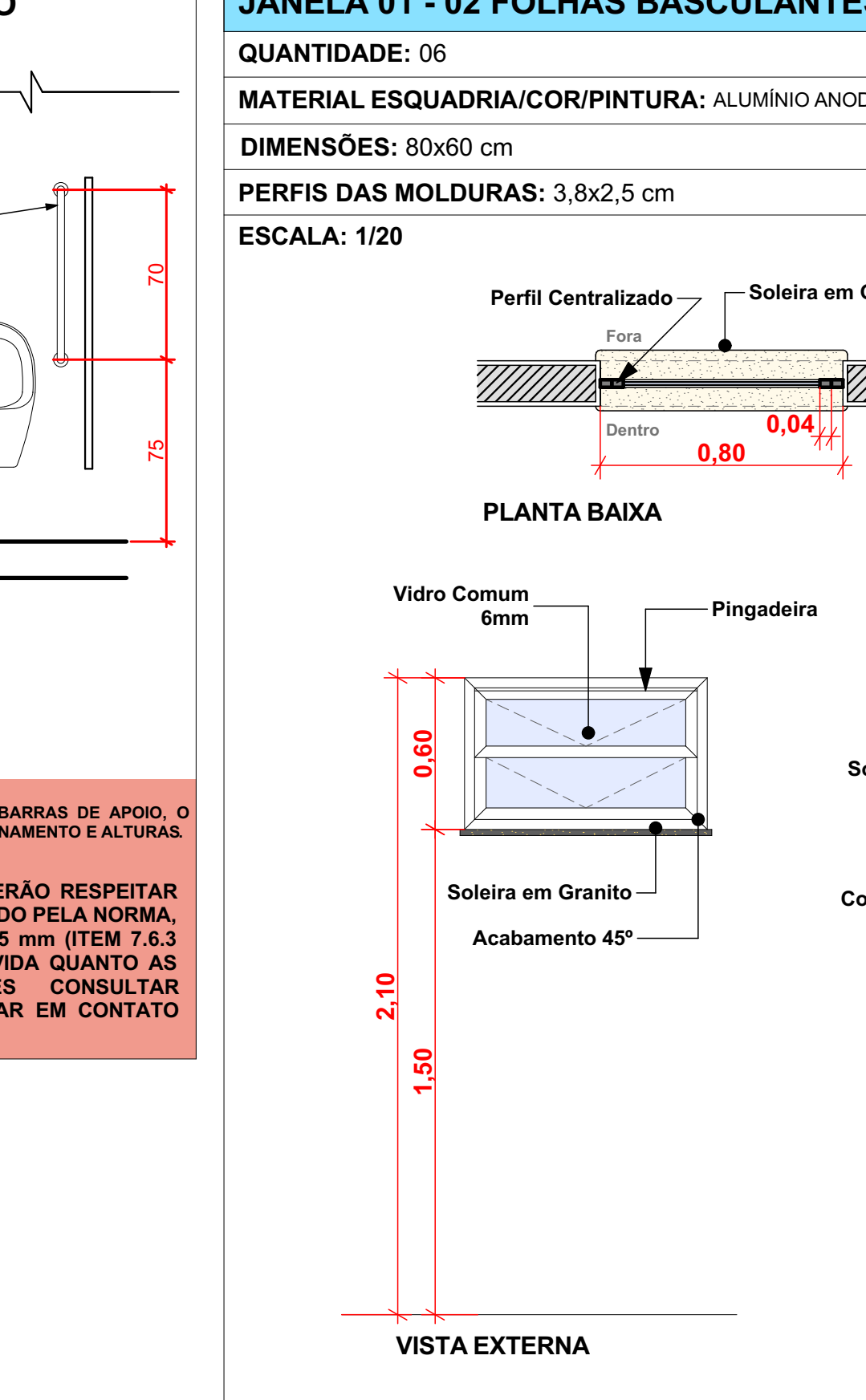

JANELA 02 - 12 FOLHAS BASCULANTES

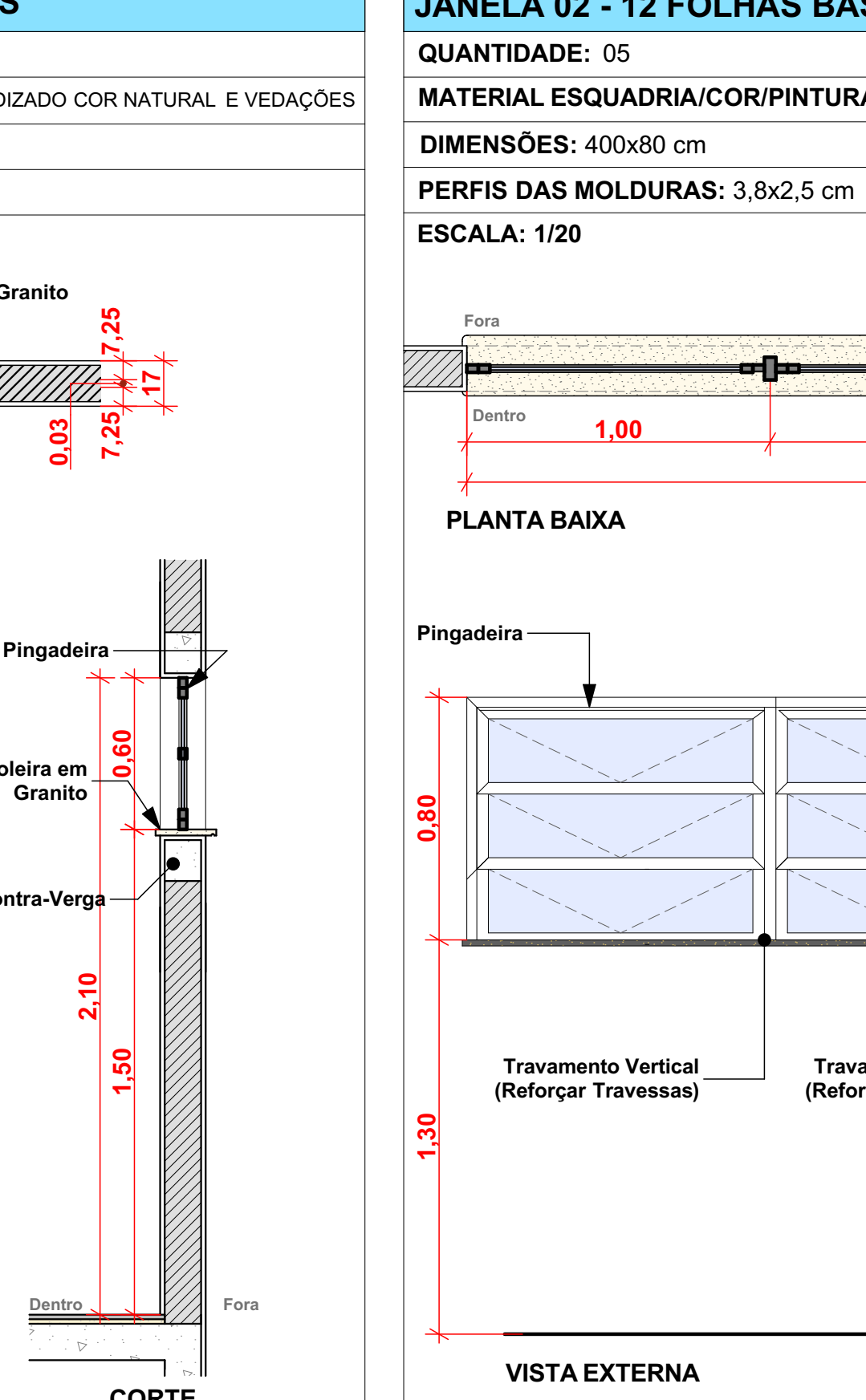

DETALHE 05 - SANITÁRIO ACESSÍVEL

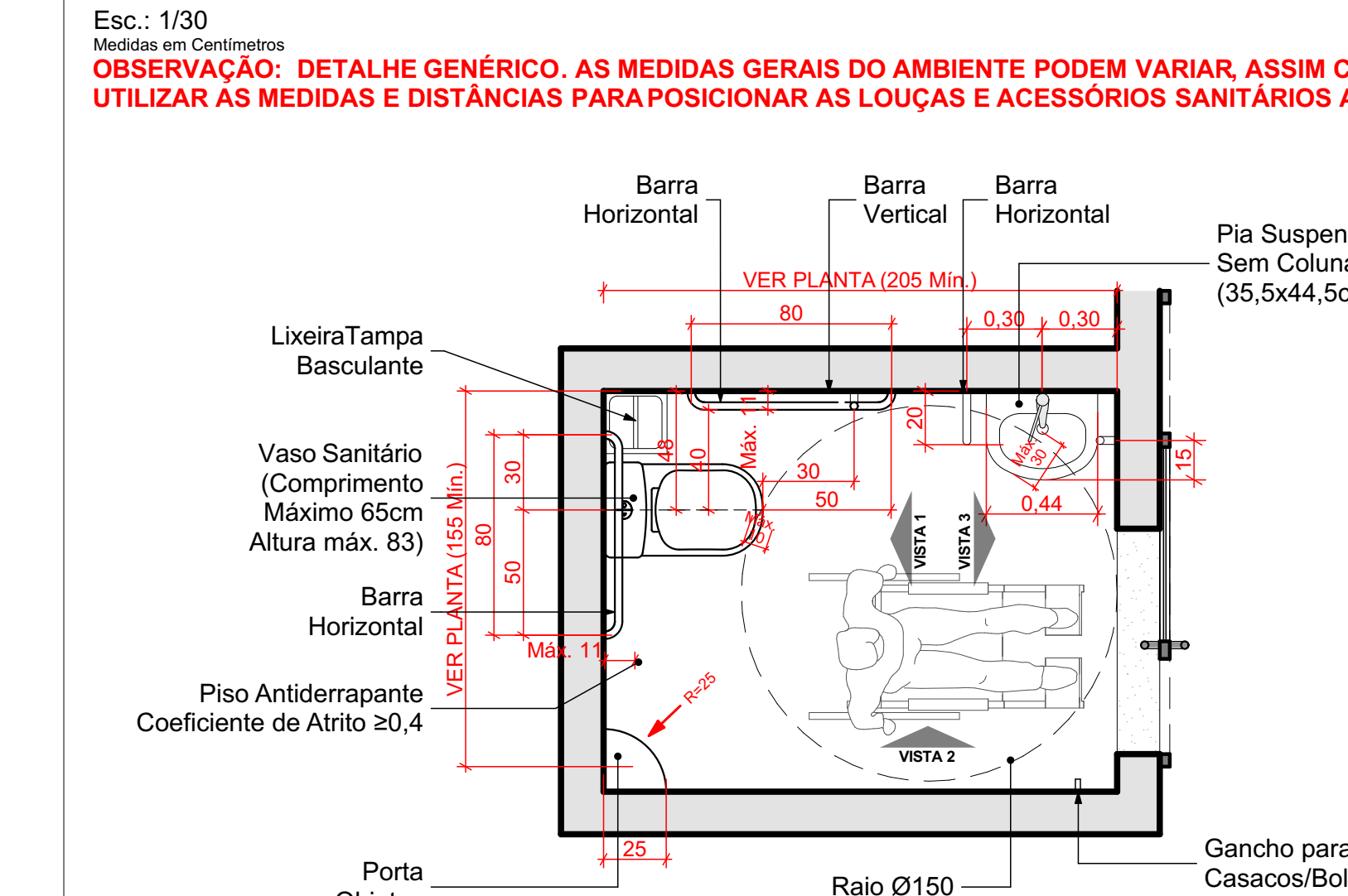

PORTA DE CORRER SANITÁRIO ACESSÍVEL

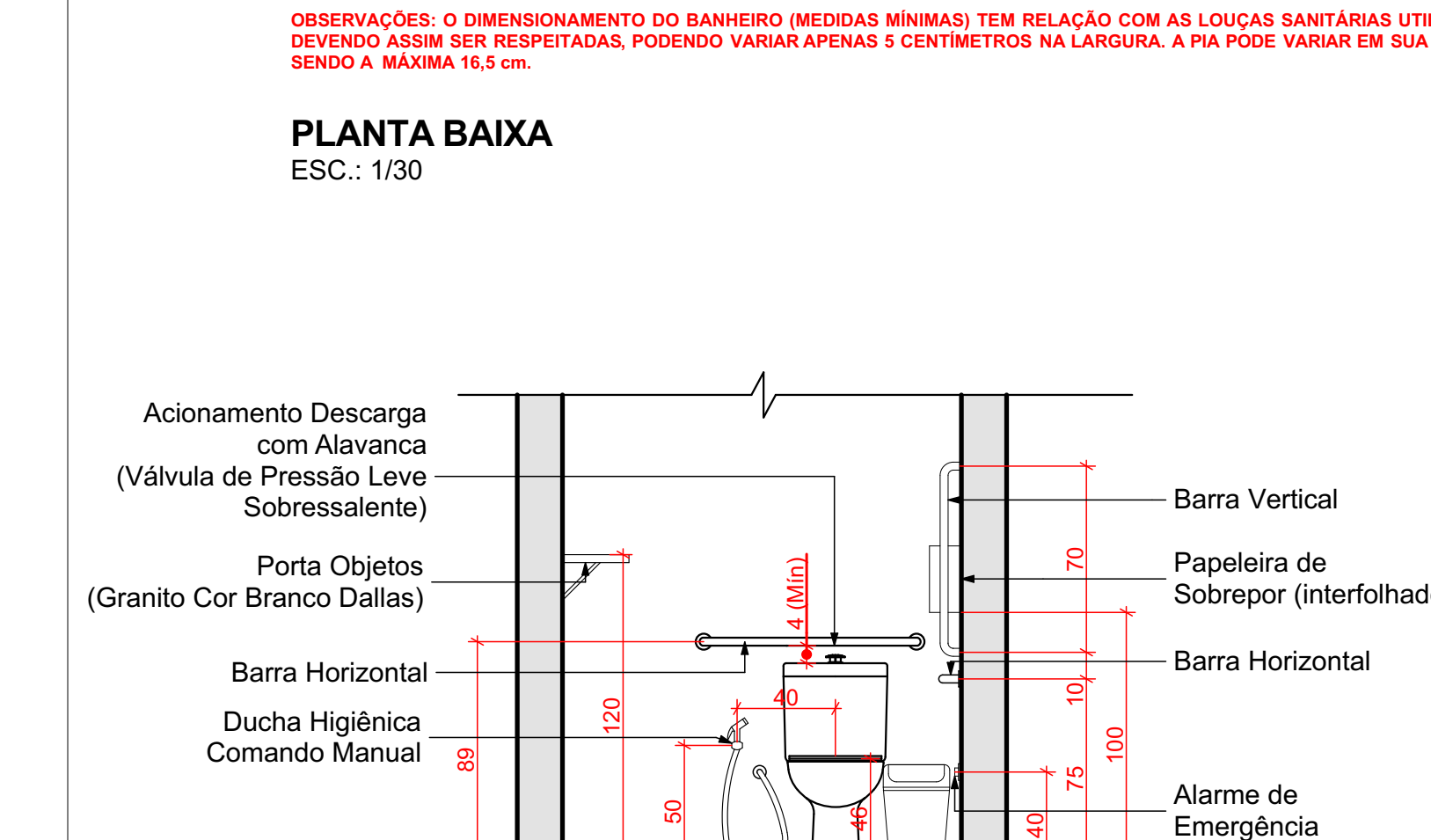

PORTA DE CORRER SANITÁRIO ACESSÍVEL

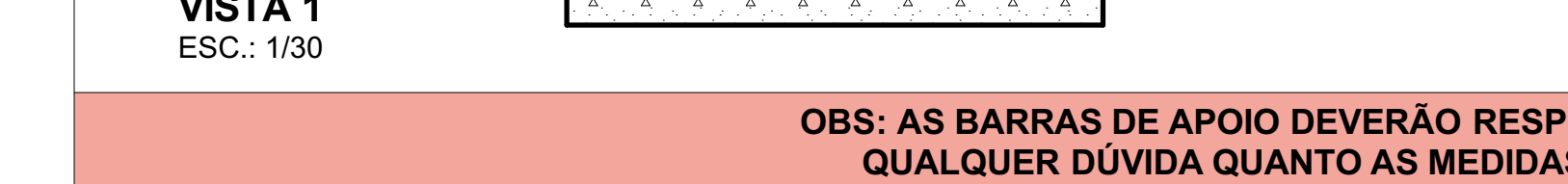

PORTA DE CORRER SANITÁRIO ACESSÍVEL



PORTA DE CORRER SANITÁRIO ACESSÍVEL

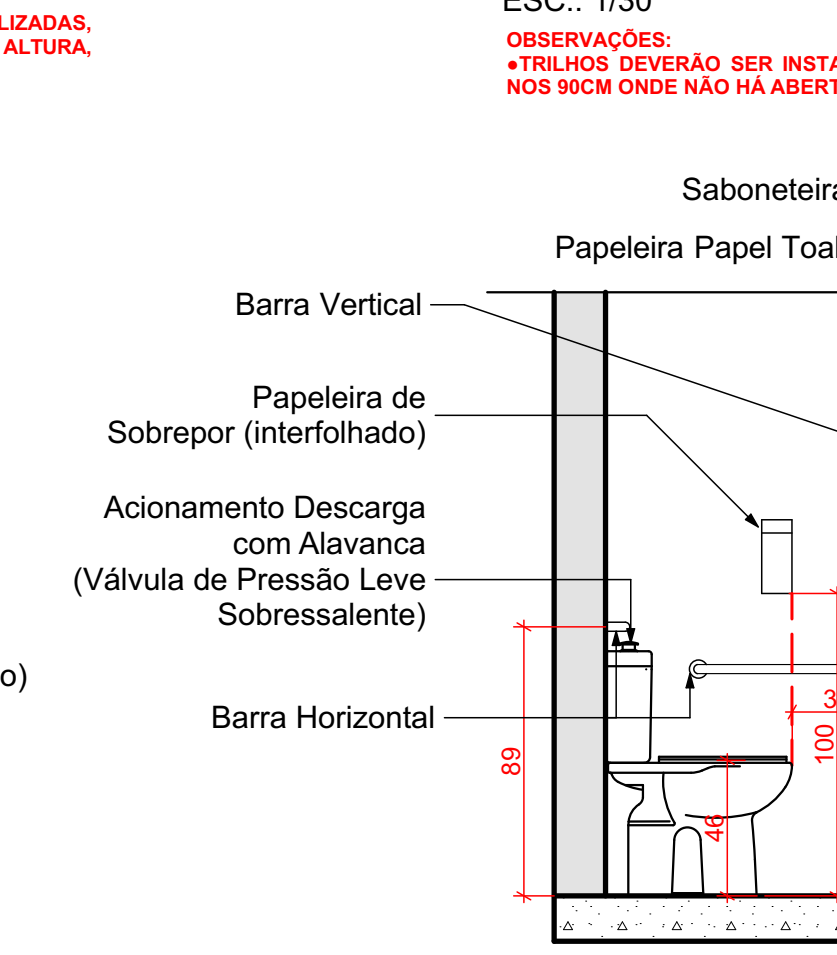

PORTA DE CORRER SANITÁRIO ACESSÍVEL



PORTA DE CORRER SANITÁRIO ACESSÍVEL

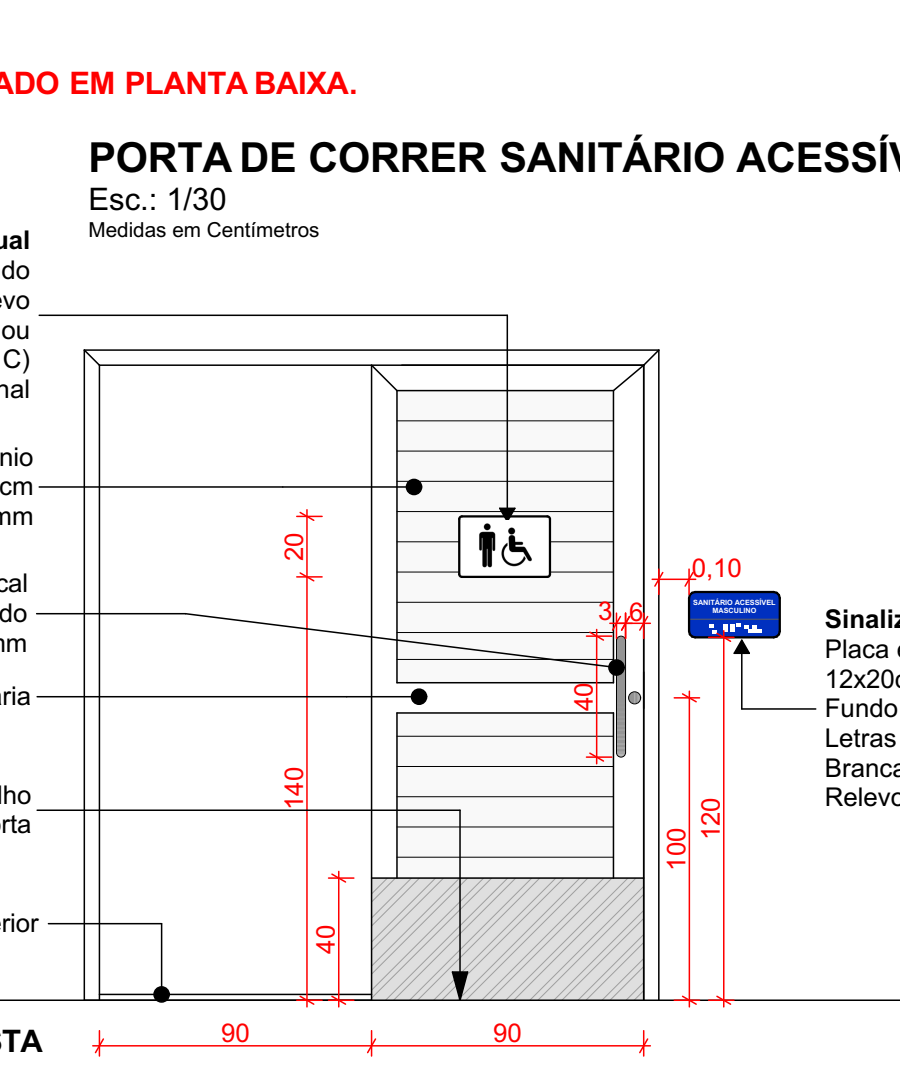

PORTA DE CORRER SANITÁRIO ACESSÍVEL

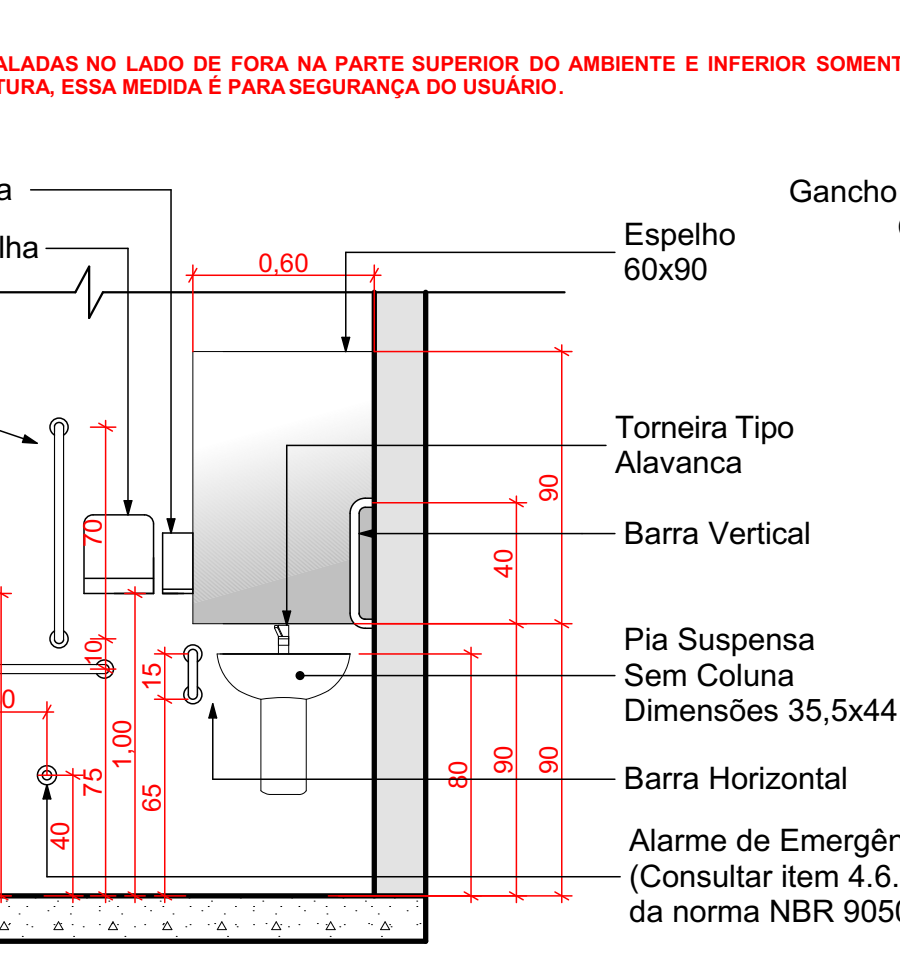

PORTA DE CORRER SANITÁRIO ACESSÍVEL

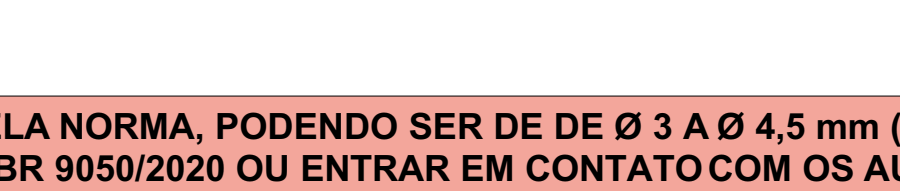

PORTA DE CORRER SANITÁRIO ACESSÍVEL

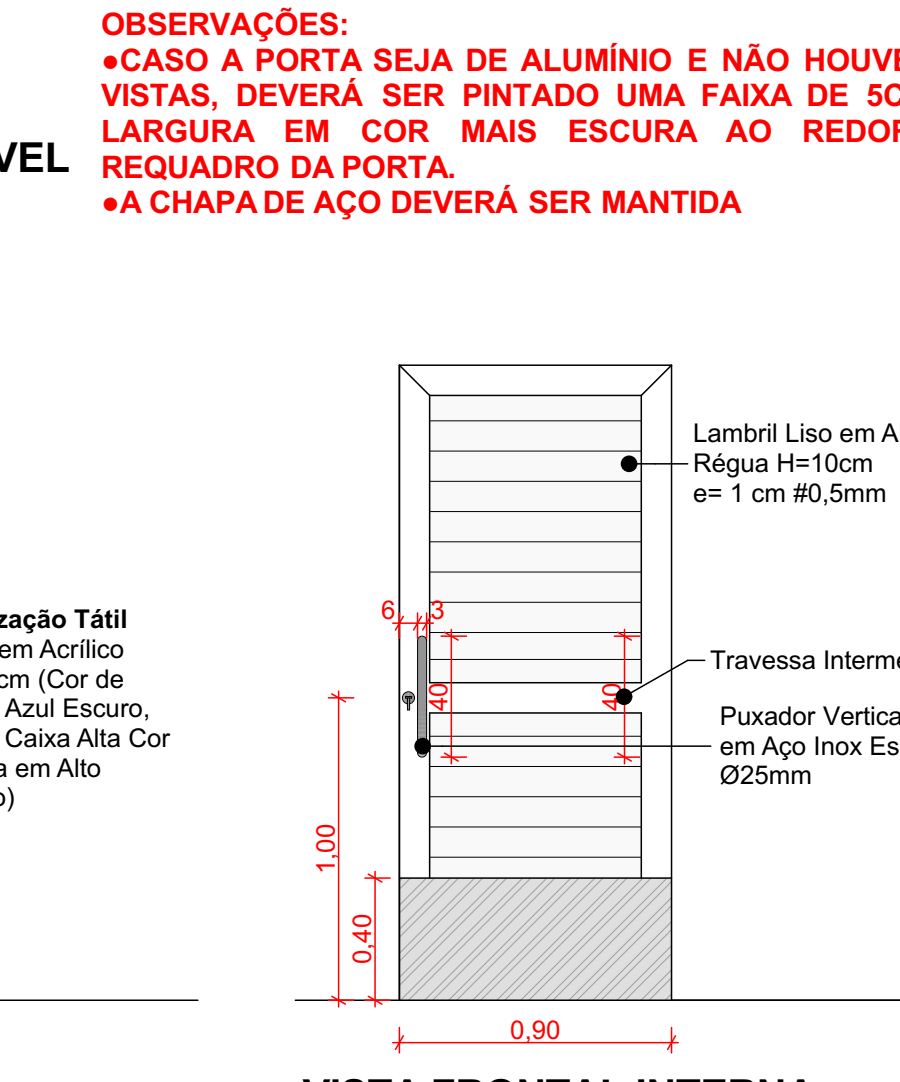

PORTA DE CORRER SANITÁRIO ACESSÍVEL

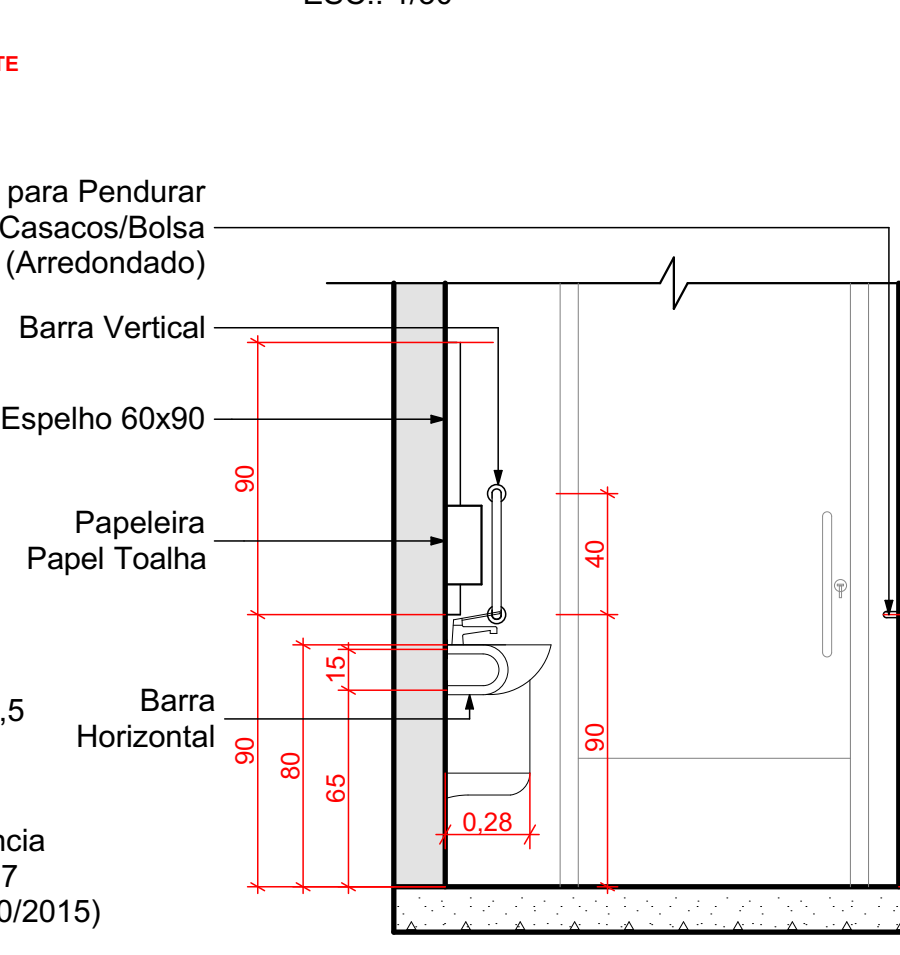

PORTA DE CORRER SANITÁRIO ACESSÍVEL

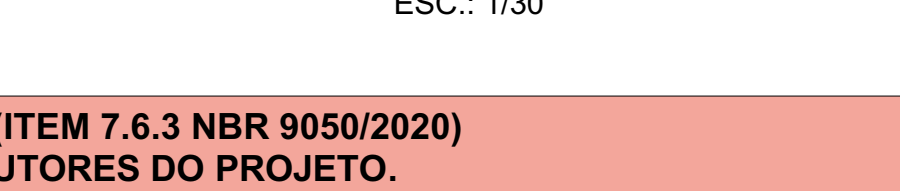

PORTA DE CORRER SANITÁRIO ACESSÍVEL

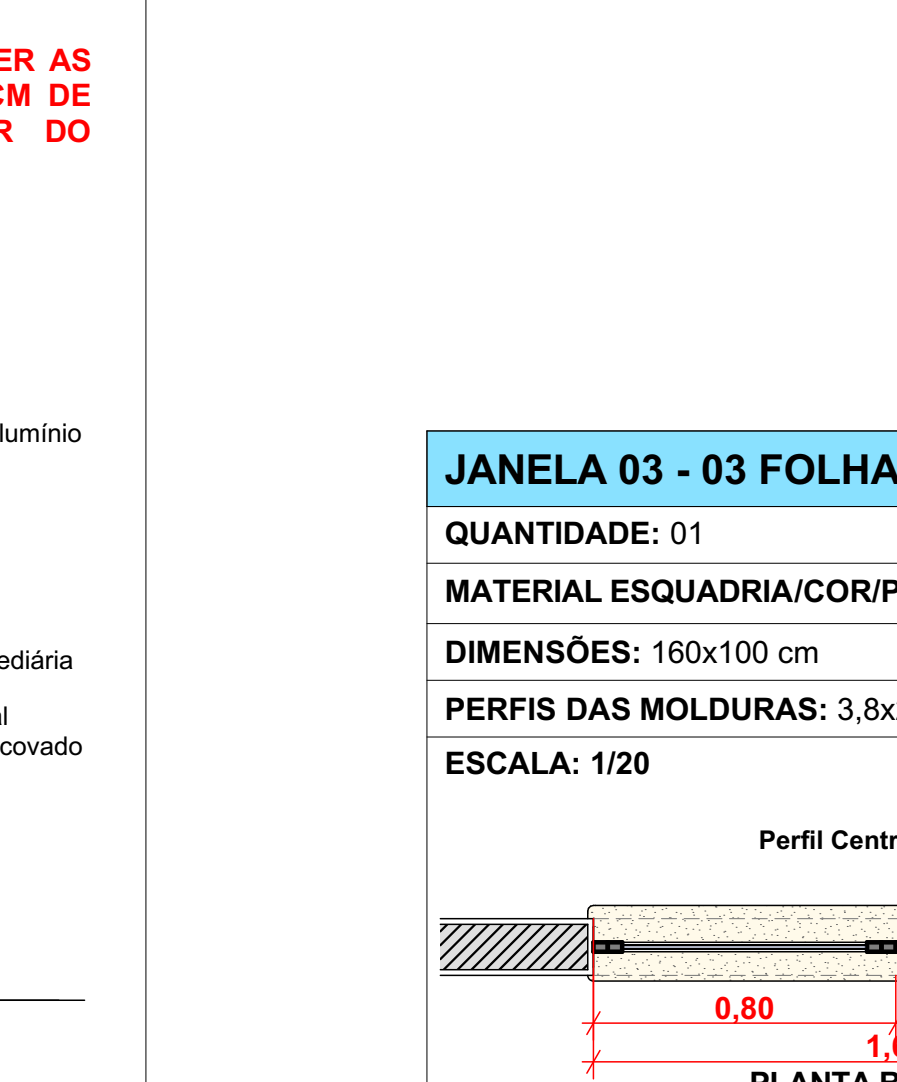

PORTA DE CORRER SANITÁRIO ACESSÍVEL

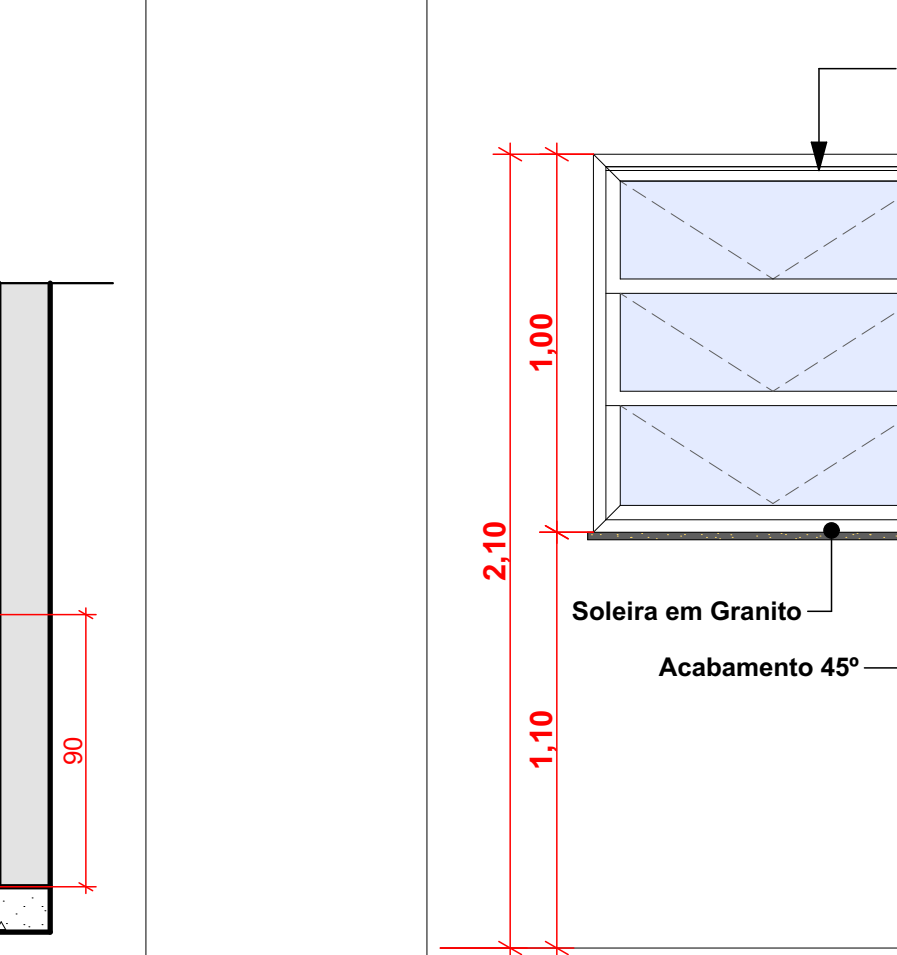

PORTA DE CORRER SANITÁRIO ACESSÍVEL

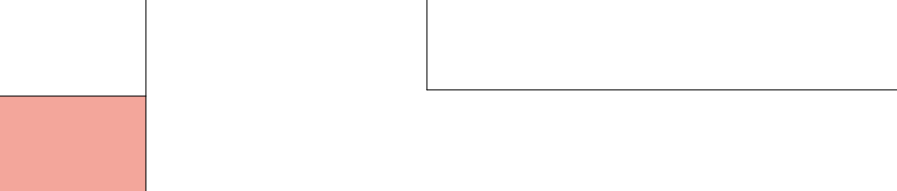

PORTA DE CORRER SANITÁRIO ACESSÍVEL

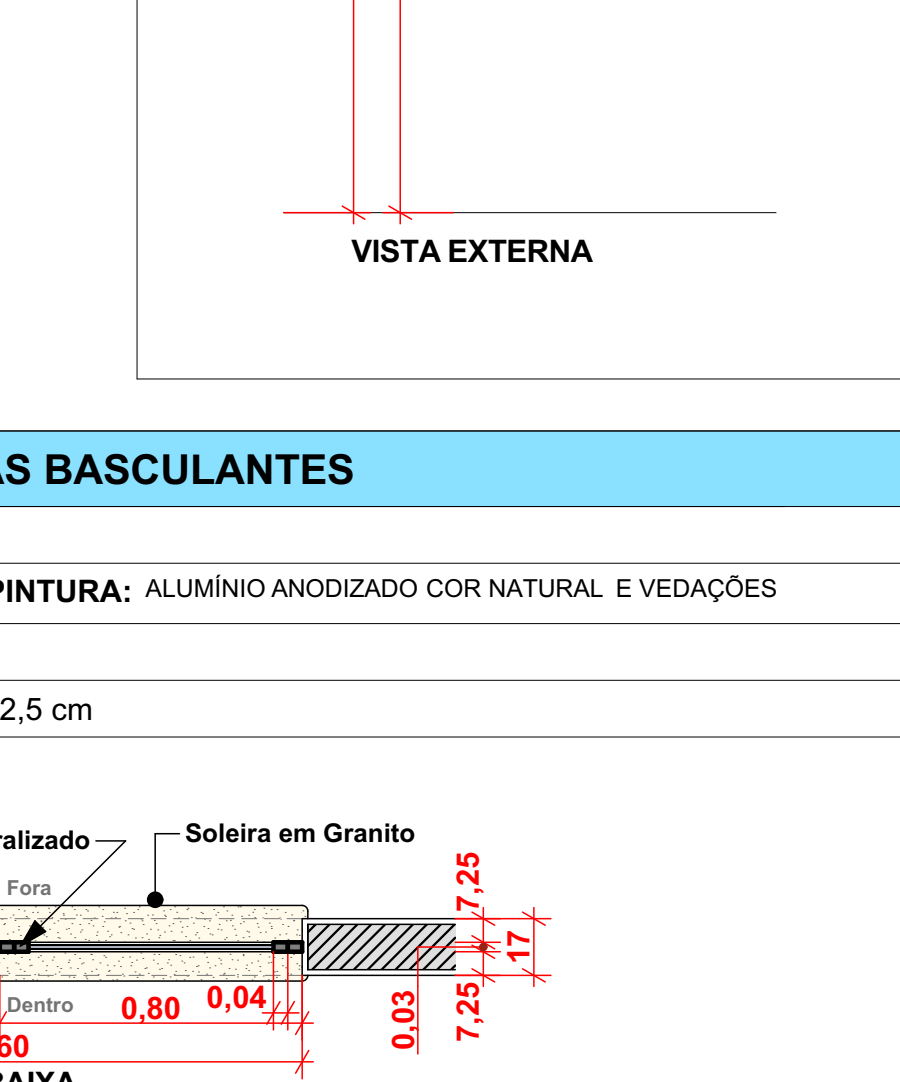

PORTA DE CORRER SANITÁRIO ACESSÍVEL

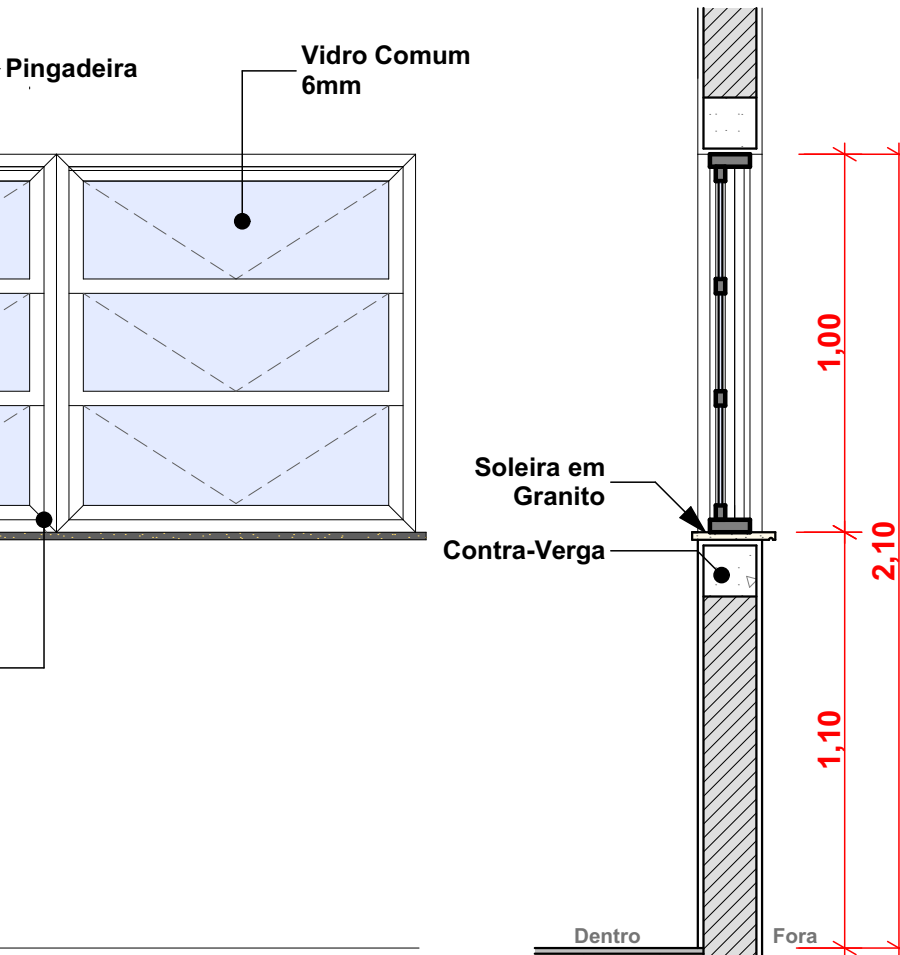

PORTA DE CORRER SANITÁRIO ACESSÍVEL



PORTA DE CORRER SANITÁRIO ACESSÍVEL

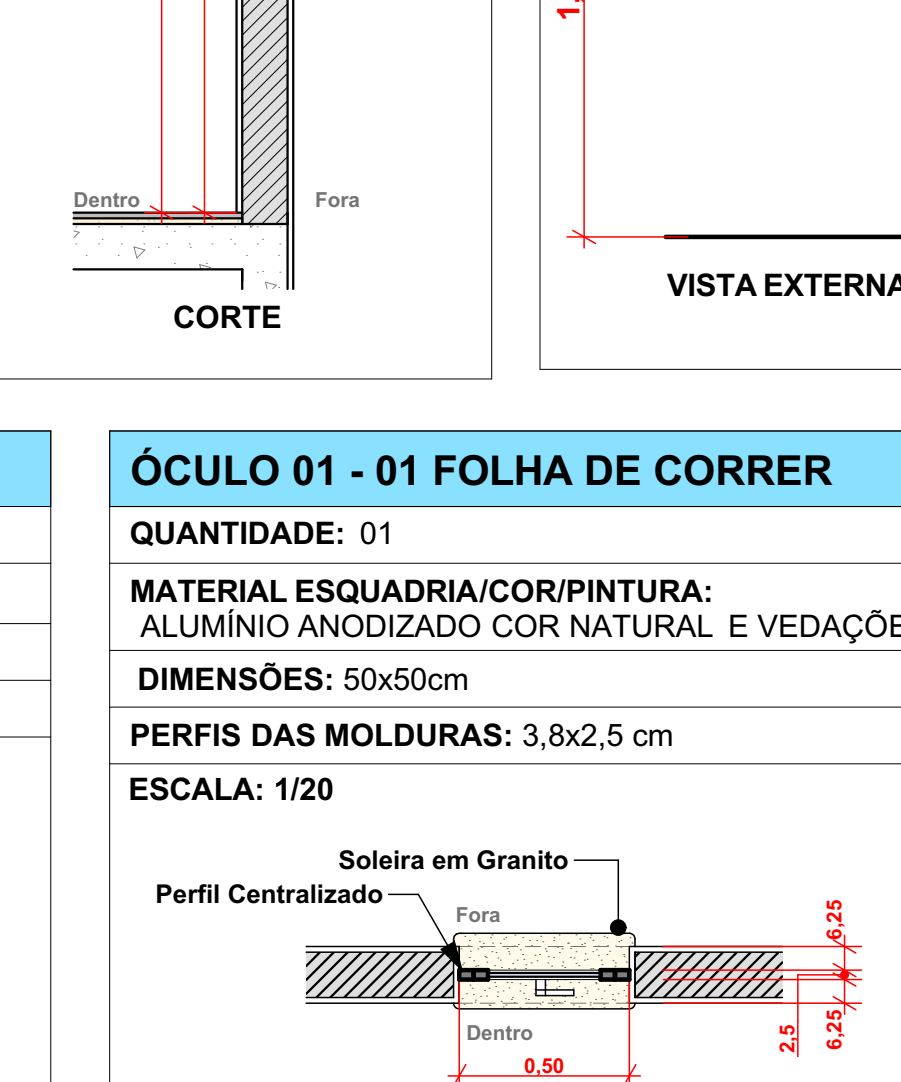

PORTA DE CORRER SANITÁRIO ACESSÍVEL

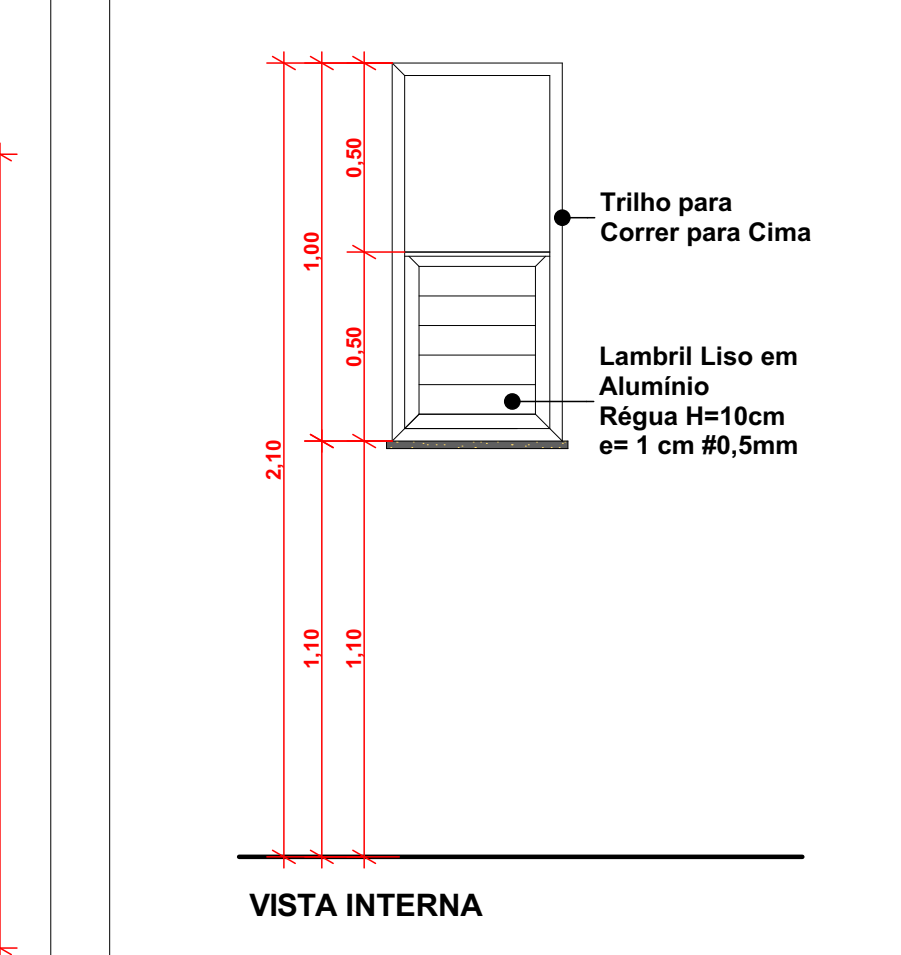

PORTA DE CORRER SANITÁRIO ACESSÍVEL



PORTA 01 - 02 FOLHAS DE GIRO

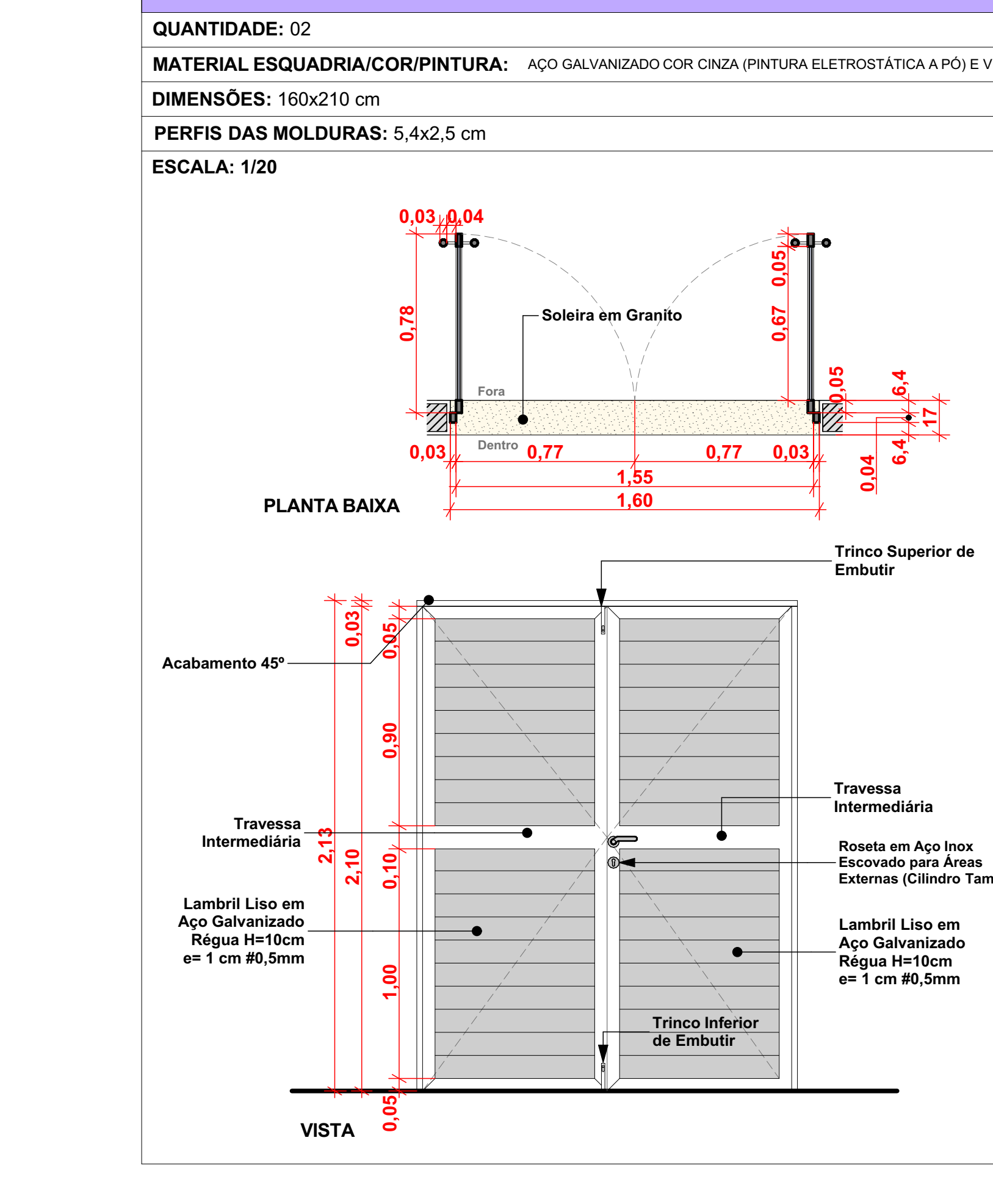

PORTA 02 - 01 FOLHA DE GIRO

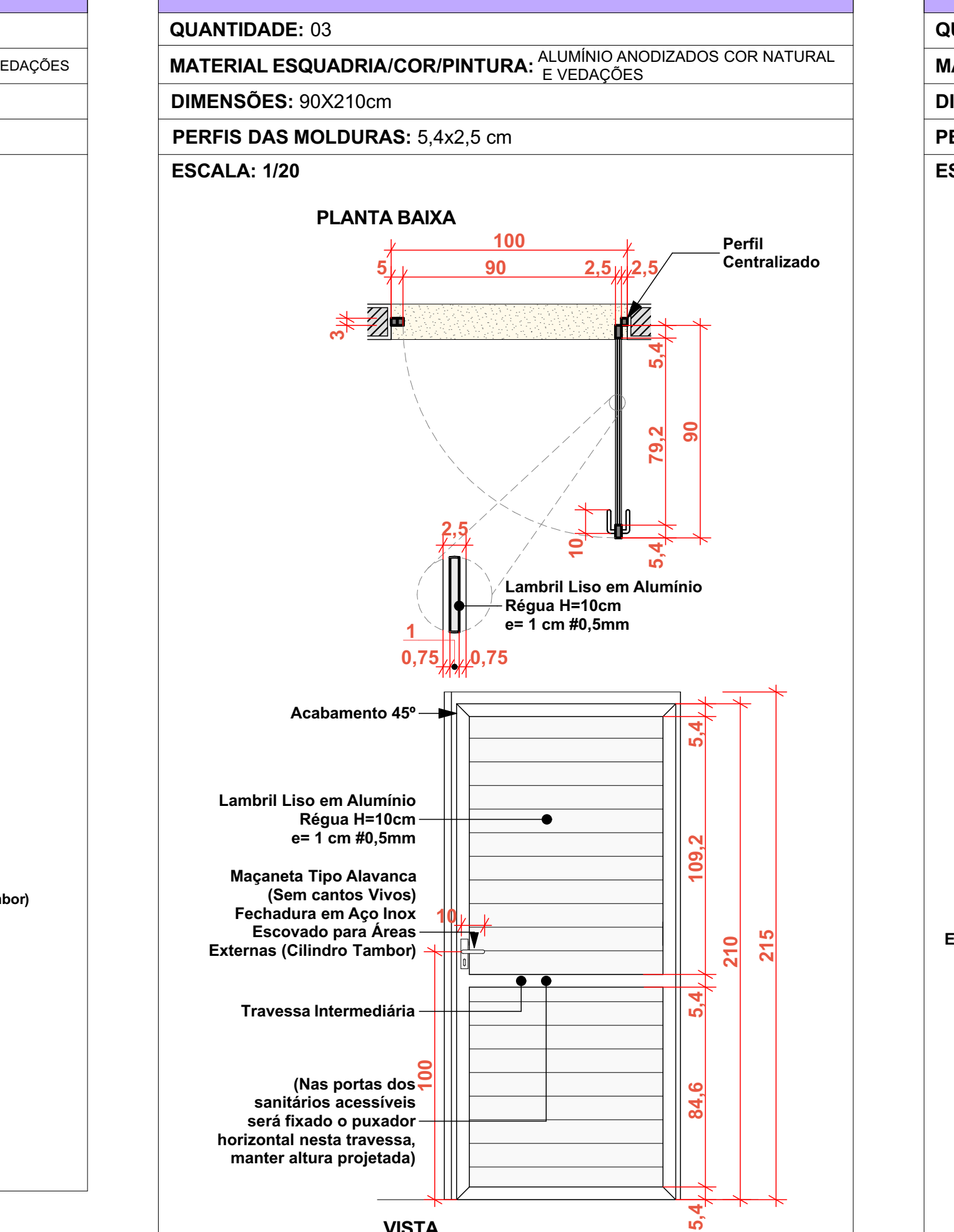

PORTA 03 - 01 FOLHA DE CORRER

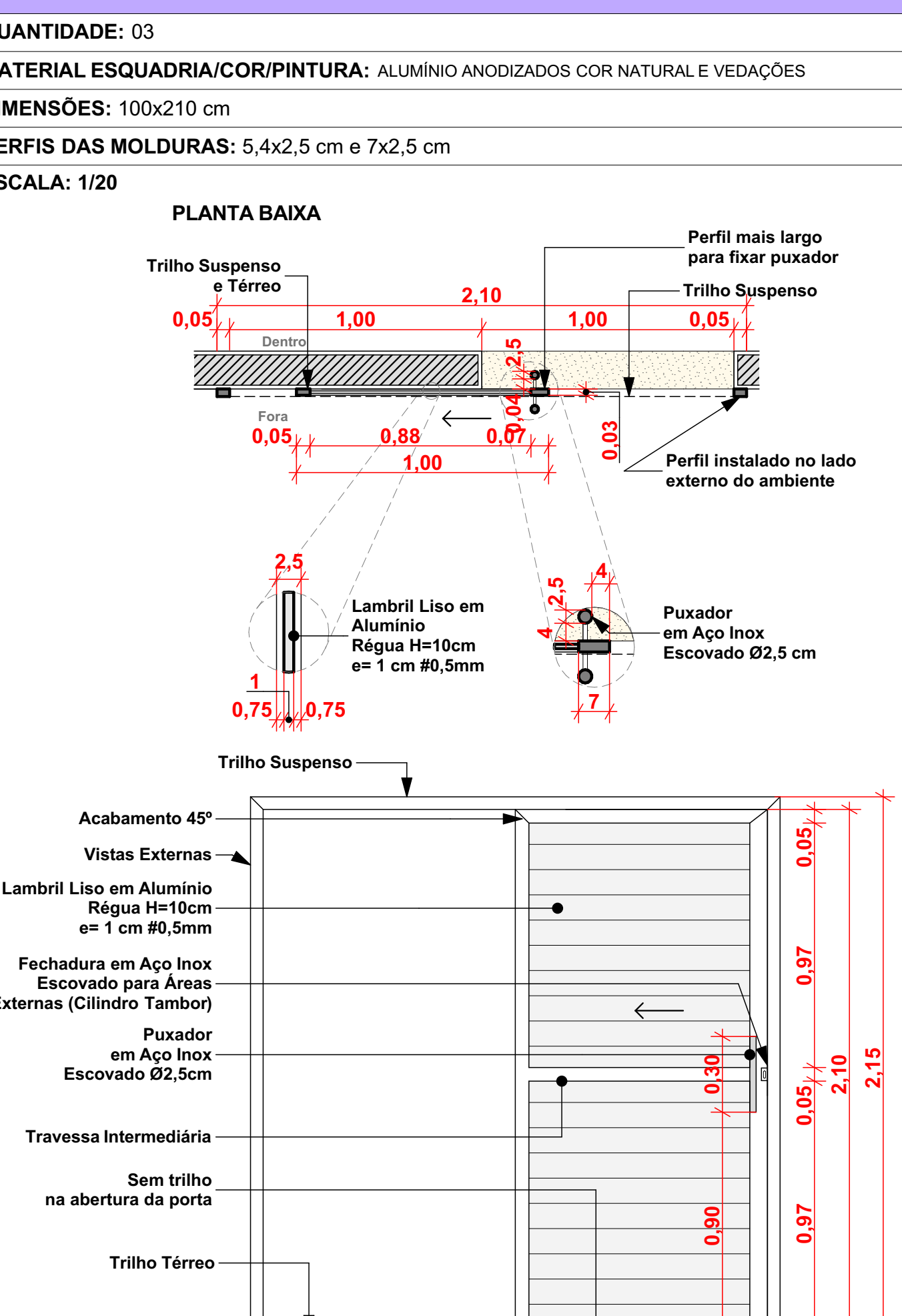

PORTA 04 - 01 FOLHA DE GIRO

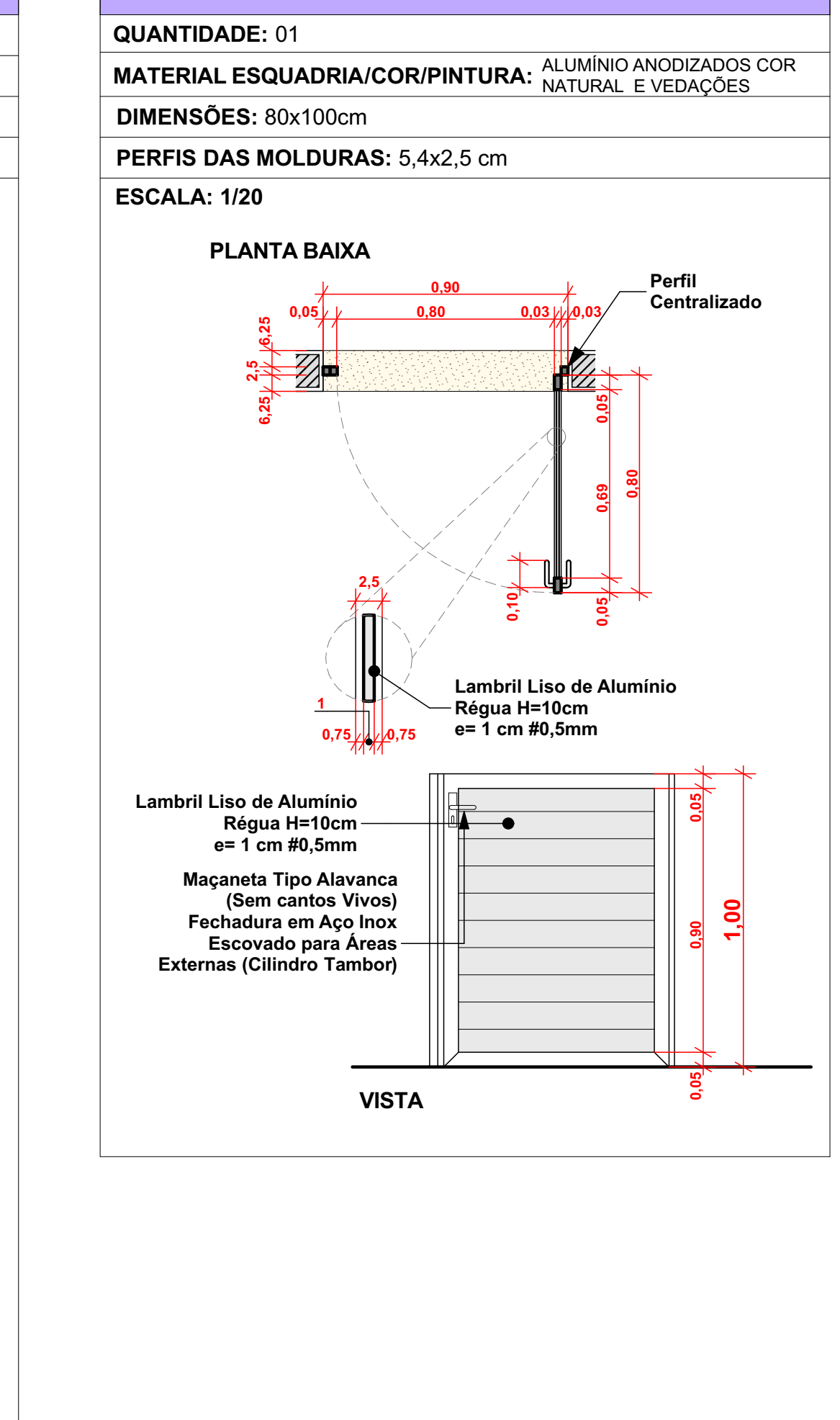

PORTA 07 - 1 FOLHA DE GIRO

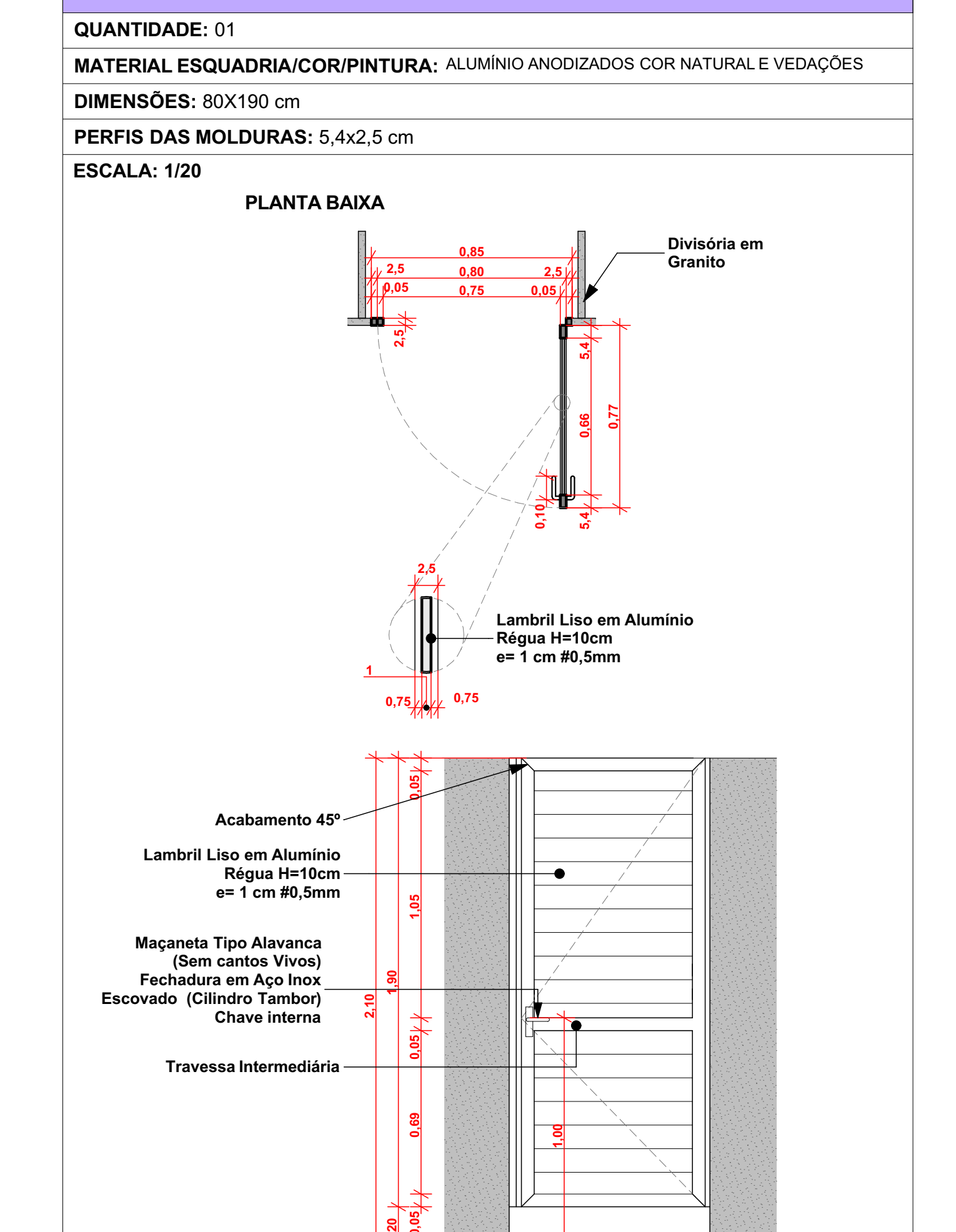

REVISÃO:	DATA:	DESCRIÇÃO:
	12/2022	EMISSÃO INICIAL
CARIMBOS E APROVAÇÕES:		
PROPRIETÁRIO / CONTRATANTE:	ASSINATURA:	
PREFEITURA MUNICIPAL DE ATALANTA		
CNPJ: 83.102.816/0001-09		
RESPONSÁVEL TÉCNICO PROJETO:	ASSINATURA:	
LARISSA LENZ SANTOS		
ARQUITETA E URBANISTA - CAU: A18155-0		
PROJETO: PROJETO ARQUITETÔNICO		
OBRA:	CANCHA DE BOCHA	
LOGRADOURO:	EST. GERAL RIBEIRÃO MATILDE	BAIRRO: RIB MATILDE Nº: S/N
MUNICÍPIO:	ATALANTA	UF: SC CEP: 89410-000
ÁREA EDIFICAÇÃO A FINALIZAR:	332,17 m²	ÁREA TOTAL: 444,94 m²
ÁREA EXTERNA A CONSTRUIR:	112,77 m²	
CONTEÚDO:	DETALHES	
ESCALA:	INDICADA	DATA: DEZEMBRO/2022
CODIGO AMAVI:	3037	
DESENHISTA:	LARISSA LENZ	